

PREPARING THE LUMINAIRE

SURFACE WALL/CEILING MOUNT LUMINAIRE: WS-BL700

SAVE THIS INSTRUCTIONS

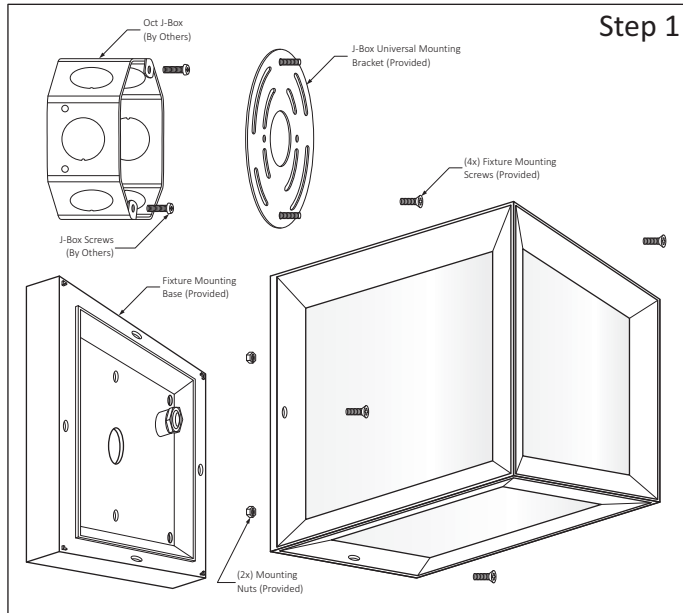

Step 1

READ AND UNDERSTAND ALL INSTRUCTIONS BEFORE INSTALLATION. IF YOU ARE NOT FAMILIAR WITH THE NATIONAL ELECTRICAL CODE (NEC), CONTACT A QUALIFIED ELECTRICIAN TO INSTALL THIS LUMINAIRE.

WARNING.- Before installing this luminaire or doing any maintenance, turn off the power supply at the circuit breaker or fuse box. Turning the power off using the light switch is not sufficient to prevent electrical shock.

NOTE:

To re-lamp, replacement parts or additional information, contact or visit manufacturer at www.lumux.com

Step 1 - Disassemble Luminaire Parts for easy Installation:
a.- Remove Fixture Mounting Plate and Bracket from Fixture.

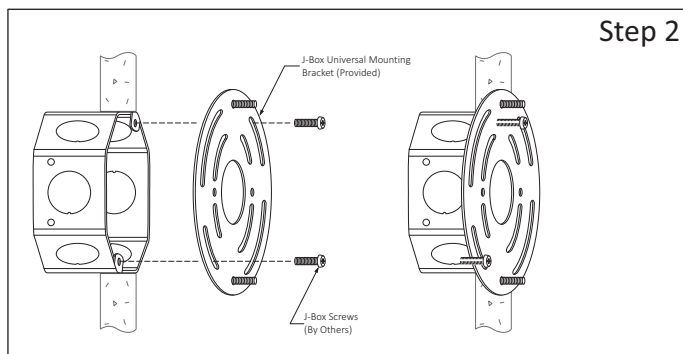

Step 2

Step 2 - Install Mounting Bracket:
a.- Place the Universal Bracket onto the Electrical Box and secure it using two J-Box Screws (By others).

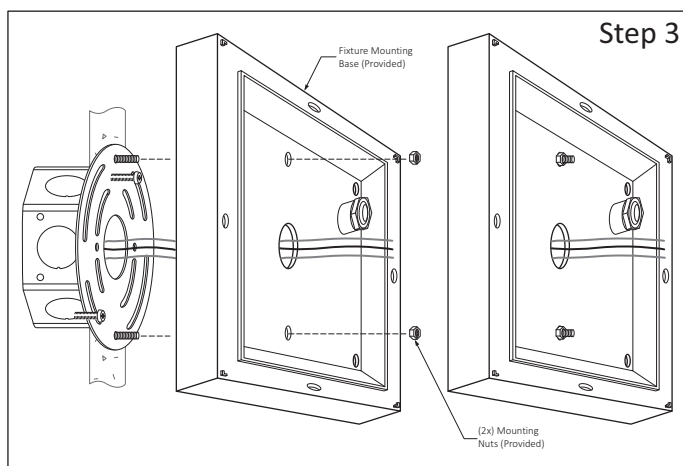

Step 3

Step 3 - Install Fixture Mounting Base:
a.- Run Input wires through center hole of Mounting Base.
b.- Insert the two 8-32 Screws (provided) through the Holes and use the Nuts (provided) to secure the Base on Mounting Surface.

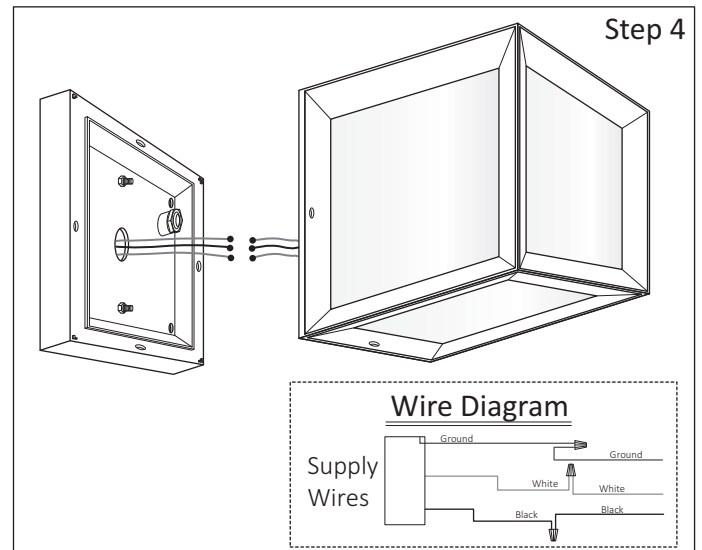

Step 4

Step 4 - Make Wiring Connections:

a.- Run the Electrical Wires through all the Parts and make hard-wire connections, see Wire Diagram.

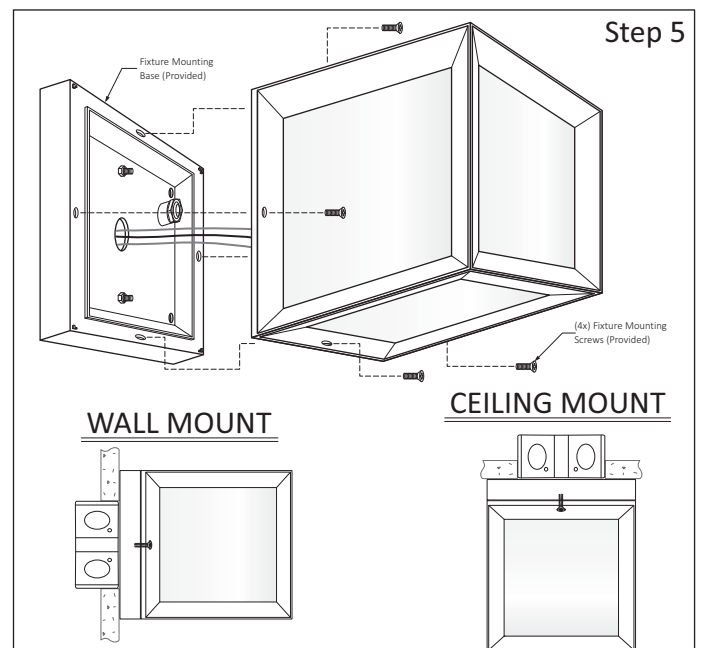

Step 5

Step 5 - Install Fixture:

a.- Place Fixture on Base and align the holes and fasten using the four Mounting Screws (provided).